

# TURNSTAR

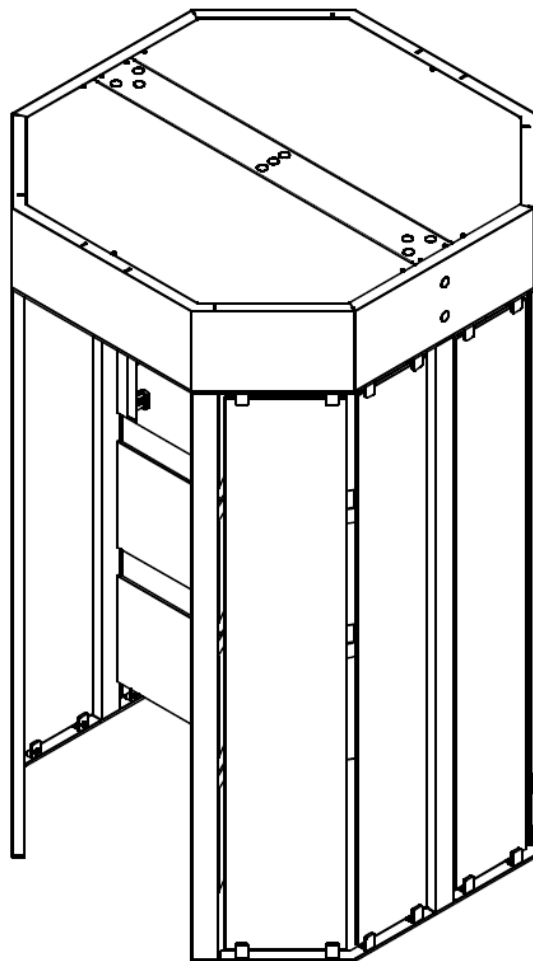

RELIABLE ★ DURABLE ★ GUARANTEED

## ASSEMBLY GUIDE



## OCTAGONAL GLASS TURNSTILE

## CONTENTS

<b>1. COPYRIGHT &amp; LIABILITY .....</b>	<b>3</b>
<b>2. SINGLE TURNSTILE ASSEMBLY .....</b>	<b>4</b>
2.1. Side Frame A Assembly.....	4
2.2. Side Frame B with No-Go Bars Assembly.....	6
2.3. Mechanism Channel Assembly.....	8
2.4. Outer Drum Assembly.....	10
2.5. Glass assembly in Frame .....	11
2.6. Bulkhead Assembly .....	13
2.7. Mechanism Channel Assembly in Bulkhead .....	15
2.8. Ceiling Panels .....	17
2.9. Mechanism and Rotor Assembly.....	19
2.10. Top Cover Assembly .....	21

## **1. COPYRIGHT & LIABILITY**

- 1.1. No part of this module may be reproduced in any form, photocopy or otherwise, without the written permission of TURNSTAR SYSTEMS.
- 1.2. All information, drawings and diagrams may not be made public or shared with a third party.
- 1.3. the event of any breach of abovementioned copyright, the copyright of TURNSTAR SYSTEMS will be strictly enforced.

## 2. SINGLE TURNSTILE ASSEMBLY

### 2.1. Side Frame A Assembly.

2.1.1. Fit the top and base side weldments onto the three uprights using the M10 countersunk screws provided. Make sure the top and base levels are flush and no screw heads are protruding.

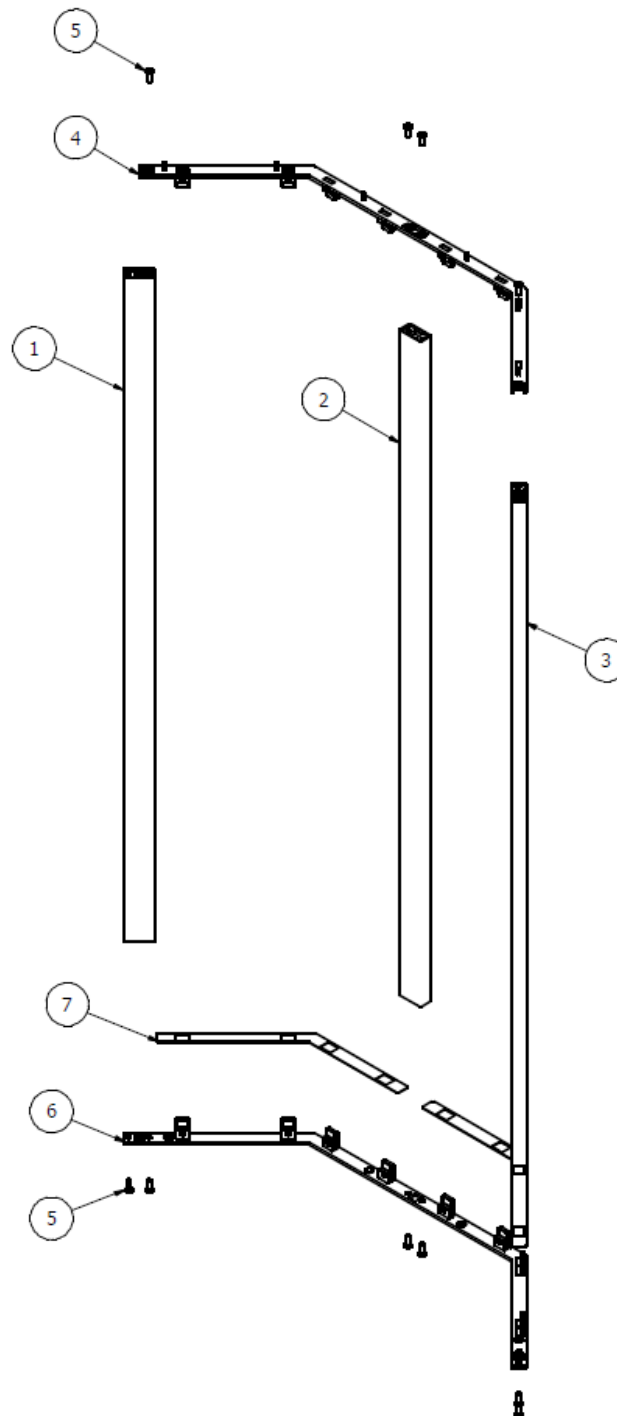

<b>NO</b>	<b>QTY</b>	<b>PART NUMBER</b>	<b>DESCRIPTION</b>
1	1	OSG-WM-16	UPRIGHT A
2	1	OSG-WM-16	UPRIGHT A
3	1	OSG-WM-16	UPRIGHT A
4	1	OSG-WM-17	TOP SIDE WELDMENT
5	10	M10x25-CSKCS-ZP	M10x25 COUNTERSUNK CAPSCREW, ZP
6	1	OSG-WM-18	BASE SIDE WELDMENT
7	2	OSG-LC-56	COVER PLATE

2.1.2. The cover plates are supplied with the Turnstile; however, this must only be placed after the frame has been bolted to the finished floor with the anchoring bolts provided (See Installation Manual).

## 2.2. Side Frame B with No-Go Bars Assembly.

2.2.1. Fit the top and base side weldments onto the three uprights using the M10 countersunk screws provided. Make sure the top and base levels are flush and no screw heads are protruding.

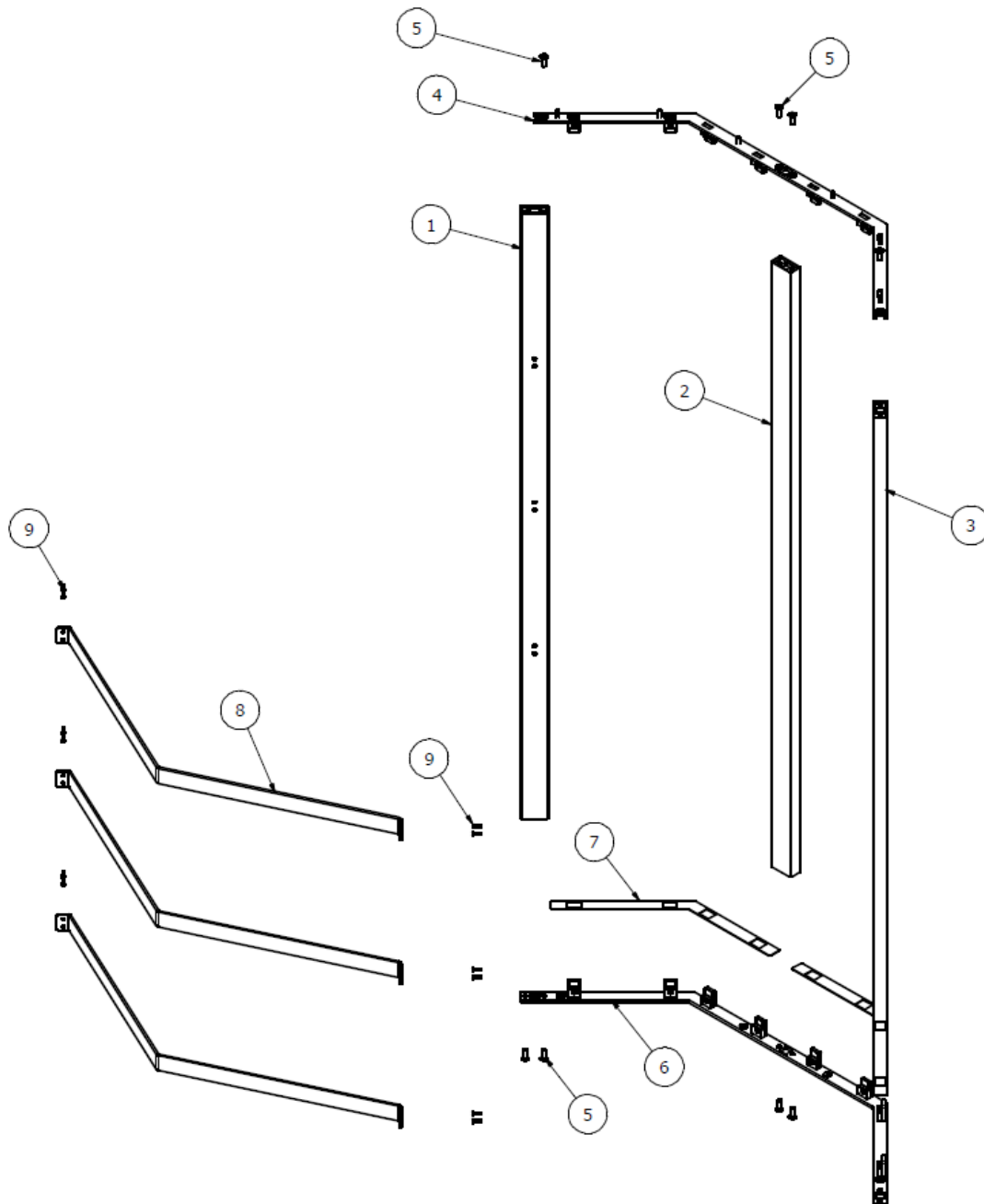

NO	QTY	PART NUMBER	DESCRIPTION
1	1	OSG-WM-19	UPRIGHT B

2	1	OSG-WM-16	UPRIGHT A
3	1	OSG-WM-19	UPRIGHT B
4	1	OSG-WM-17	TOP SIDE WELDMENT
5	10	M10x25-CSKCS-ZP	M10x25 COUNTERSUNK CAPSCREW, ZP
6	1	OSG-WM-18	BASE SIDE WELDMENT
7	2	OSG-LC-56	COVER PLATE
8	3	OSG-LC-57	NO-GO PLATE
9	12	M6x20-BHCS-ZP	M6x20 BUTTONHEAD CAPSCREWS, ZP

2.2.2. The cover plates are supplied with the Turnstile; however, this must only be placed after the frame has been bolted to the finished floor with the anchoring bolts provided (See Installation Manual).

2.2.3. Fit the No-Go Plates onto two of the uprights as shown, using the M6 button-head screws supplied.

2.3. Mechanism Channel Assembly.

2.3.1. Fit the top mechanism and control panel onto the channel weldment using the M12 hex bolts and hex nuts.

2.3.2. Fit the override lock barrels into the mechanism and the camlock body to the barrel. Place the camlock nut over the camlock body.

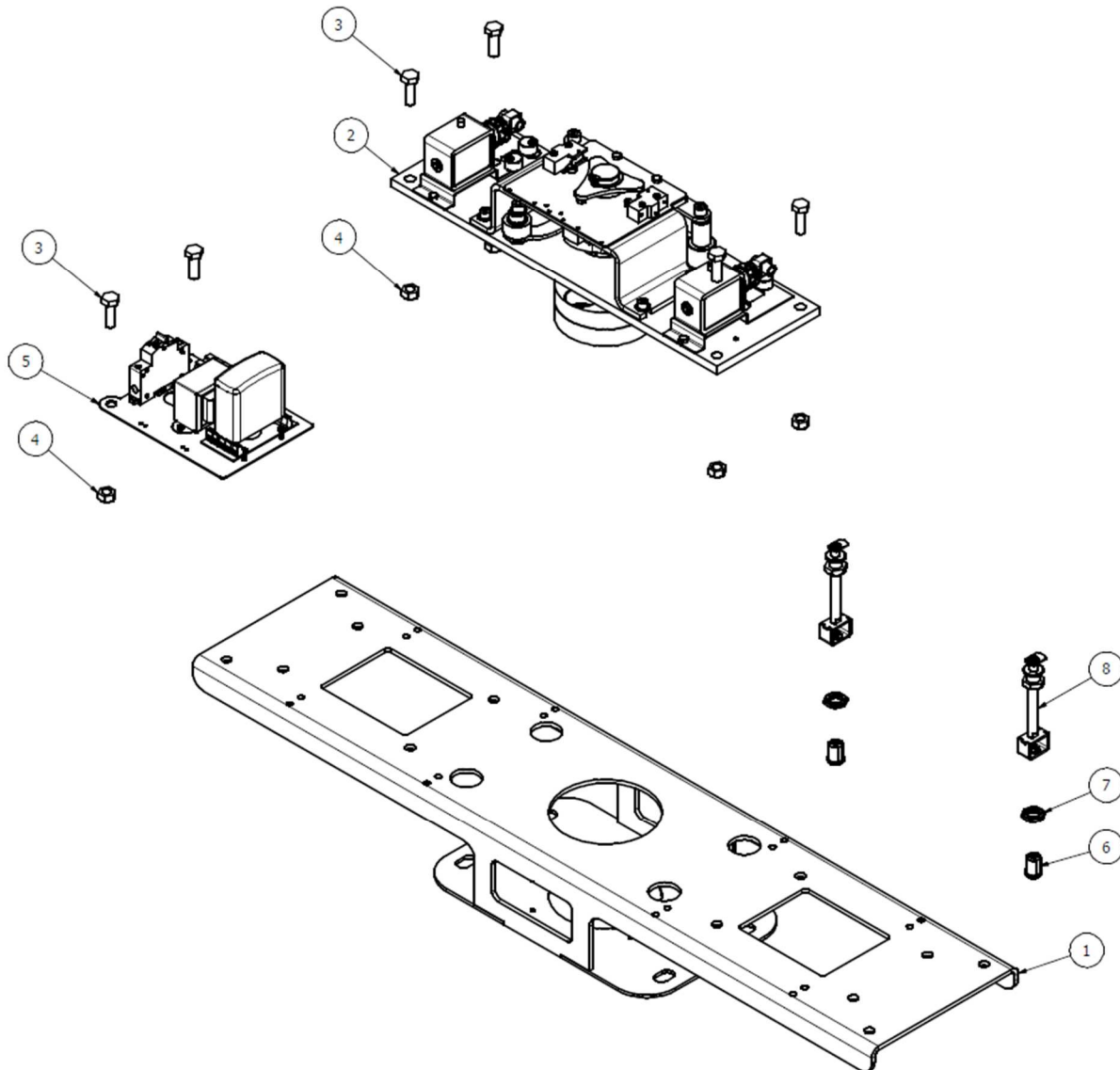

NO	QTY	PART NUMBER	DESCRIPTION
1	1	OSG-WM-11	MECHANISM CHANNEL WELDMENT
2	1	TSM-AS-02	3-ARM FH MECHANISM - FAIL SECURE



3	6	M12x35-HB-ZP	M12x35 HEXBOLT, ZP
4	6	M12-HN-ZP	M12 HEXNUT, ZP
5	1	CP-AS-03	FULL HEIGHT CONTROL PANEL ASSY
6	2	PP-CML-22	CAMLOCK BODY 22mm
7	2	PP-CML-NT	CAMLOCK NUT
8	2	OSG-SA-05	LOCK BARREL ASSEMBLY

2.4. Outer Drum Assembly.

2.4.1. Fit the Cross members between the side frame assemblies and secure with M10 countersunk screws.

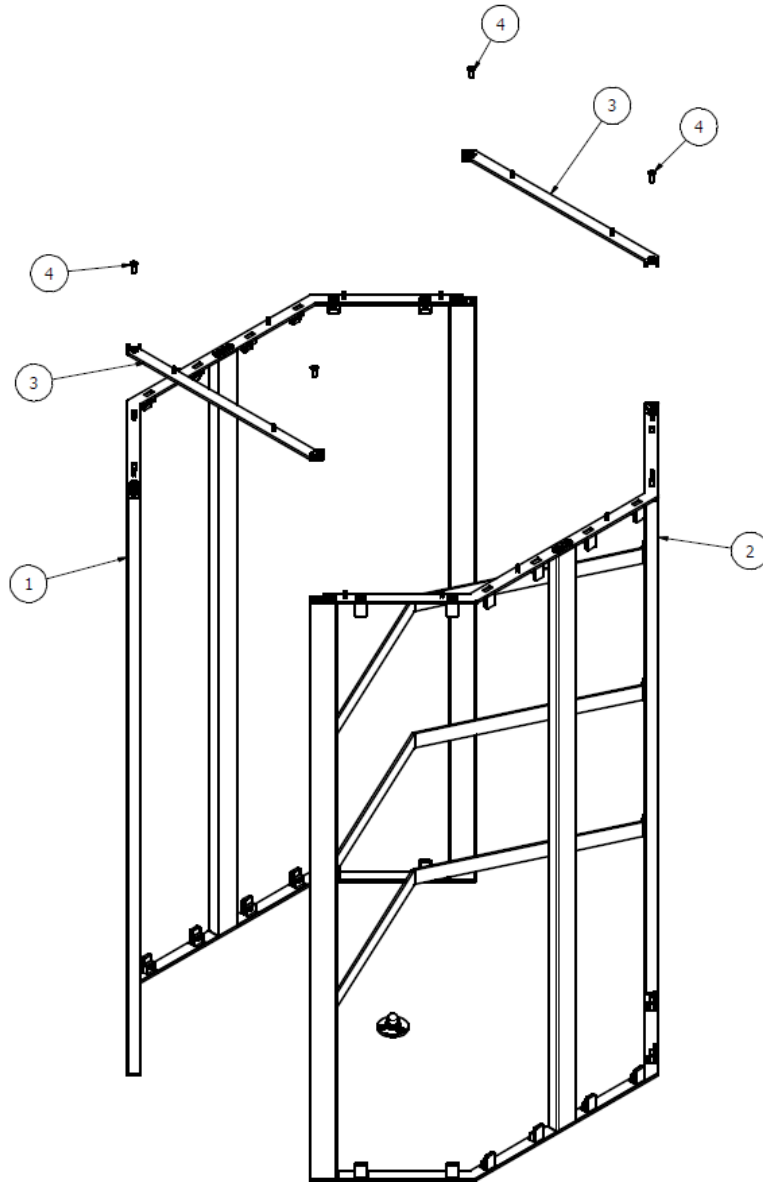

NO	QTY	PART NUMBER	DESCRIPTION
1	1	OSG-SA-11	SIDE FRAME A ASSEMBLY
2	1	OSG-LC-12	SIDE FRAME B NO-GO ASSEMBLY
3	2	OSG-WM-22	CROSS MEMBER WELDMENT
4	4	M10x25-CSKCS-ZP	M10x25 COUNTERSUNK CAPSCREW, ZP

## 2.5. Glass assembly in Frame

- 2.5.1. Fit glass in frame using clamps, rubbers and M8 countersunk screws. The rubbers should be glued in place on the clamps.
- 2.5.2. Fit each glass on the rubber setting block in the clamp body welded to the frame. The glass should be 21mm away from the steel uprights.
- 2.5.3. Note well: The cover plates shown in 2.1 and 2.2 must be be placed before the glass is assembled. This will not fit over the clamps when the glass is in.

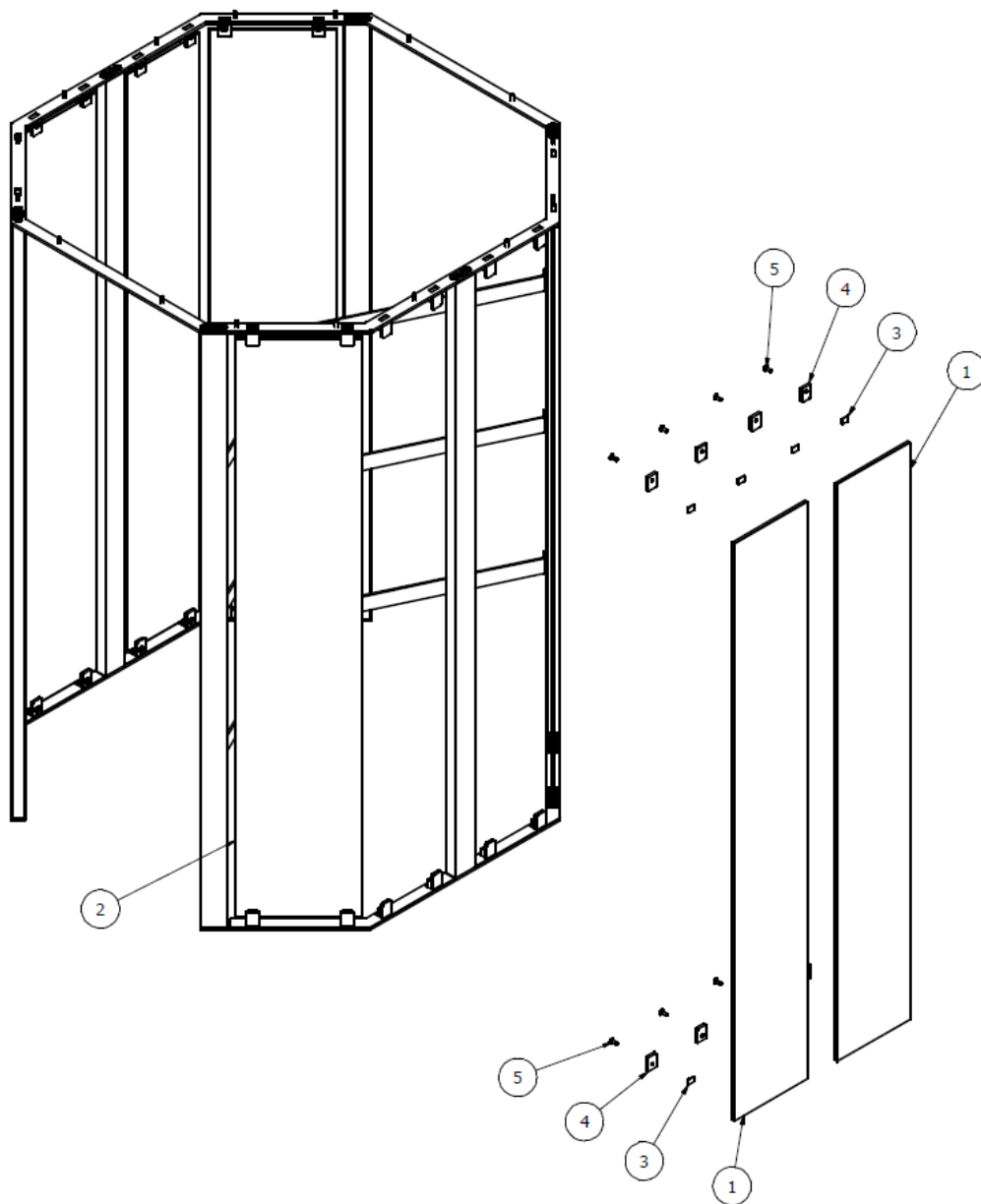

<b>NO</b>	<b>QTY</b>	<b>PART NUMBER</b>	<b>DESCRIPTION</b>
1	1	OSG-PT-01	GLASS A FOR SIDE FRAME
2	1	OSG-PT-02	GLASS B FOR SIDE FRAME
3	32	OSG-PT-04	RUBBER
4	32	OSG-LC-55	CLAMP PLATE
5	32	M8x16-CSKCS-ZP	M8x16 COUNTERSUNK CAPSCREW, ZP

## 2.6. Bulkhead Assembly

2.6.1. Fit the bulkhead weldments onto the top plates of the turnstile, locating using the studs protruding from the top plates. Fit M8 hex nuts onto the studs.

2.6.2. Tighten the bulkhead weldments onto each other using M10 hex bolts and nuts as shown. Ensure the frame remains square through this process.

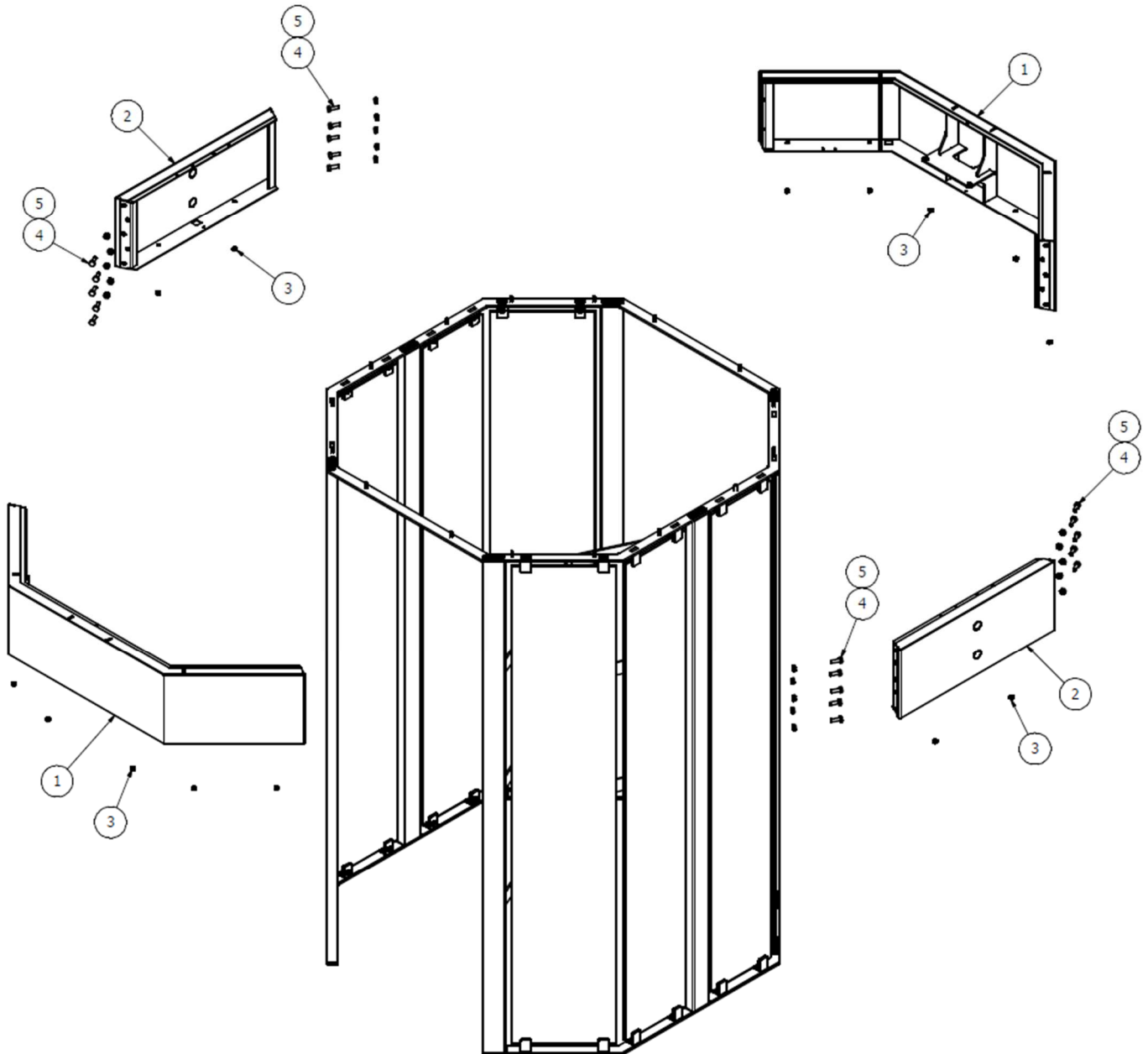

<b>NO</b>	<b>QTY</b>	<b>PART NUMBER</b>	<b>DESCRIPTION</b>
1	2	OSG-WM-24	FRONT BULKHEAD WELDMENT
2	2	OSG-WM-25	SIDE BULKHEAD WELDMENT
3	16	M8-HN-ZP	M8 HEXNUT, ZP
4	20	M10x30-HB-ZP	M10x30 HEXBOLT, ZP
5	20	M10-HN-ZP	M10 HEXNUT, ZP

## 2.7. Mechanism Channel Assembly in Bulkhead

2.7.1. Fit the mechanism channel onto the flanges inside the bulkhead. Secure with M12 Bolts and hexnuts.

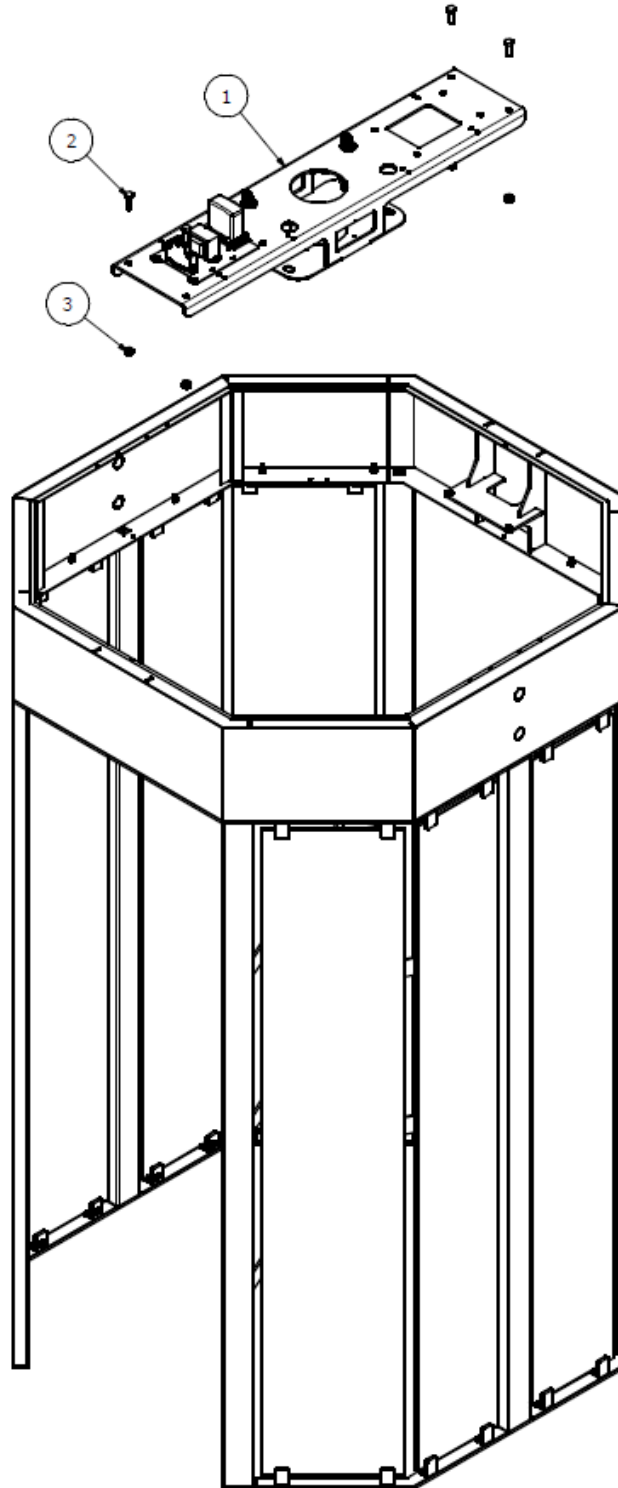

<b>NO</b>	<b>QTY</b>	<b>PART NUMBER</b>	<b>DESCRIPTION</b>
1	1	OSG-SA-03	MECHANISM CHANNEL ASSEMBLY
2	4	M12x35-HB-ZP	M12x35 HEXBOLT, ZP
3	4	M12-HN-ZP	M12 HEXNUT, ZP



## 2.8. Ceiling Panels

2.8.1. Fit the ceiling plates before fitting the mechanism and rotor using M6 button-head screws. Note the position of the override holes and the light cut-outs.

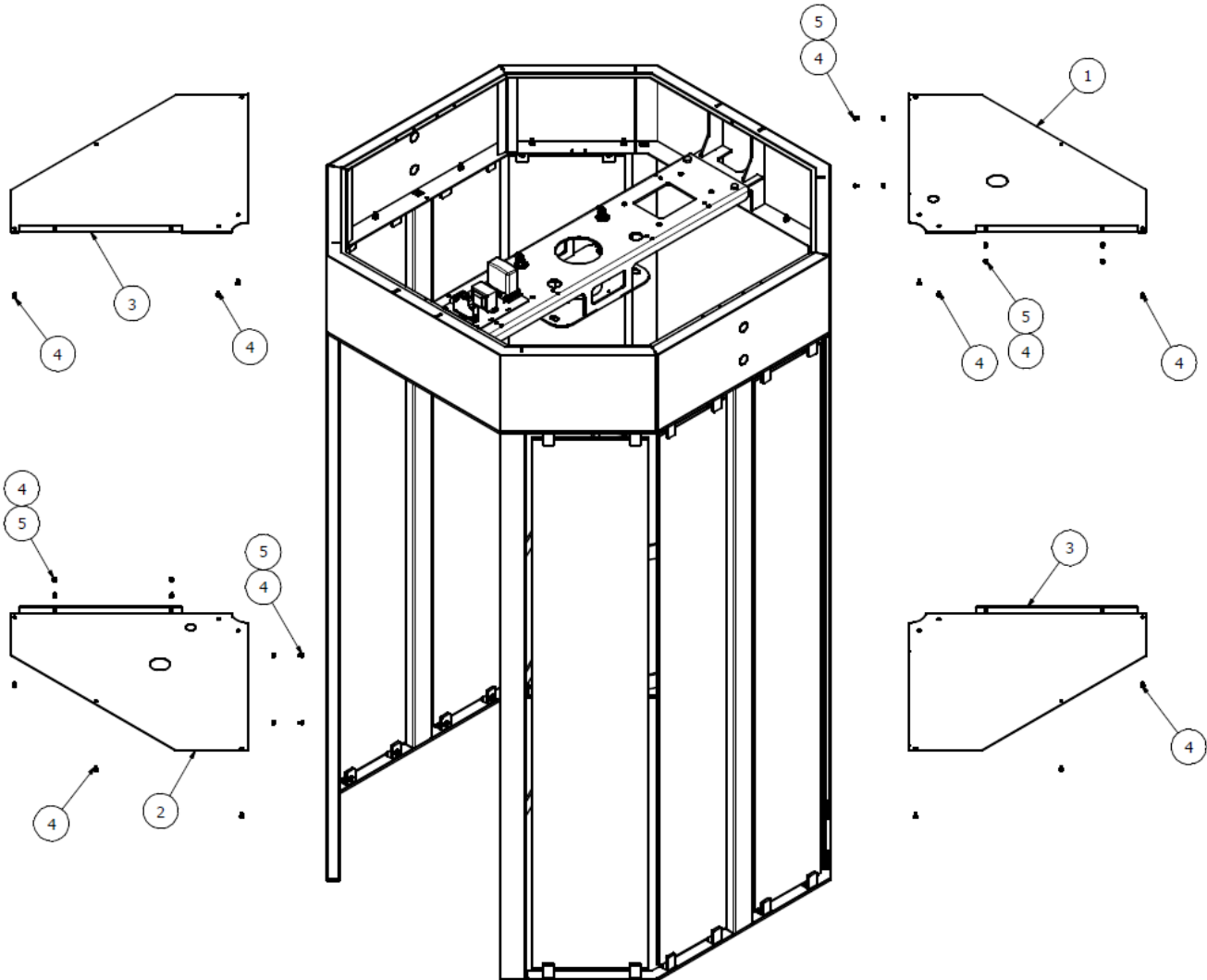

NO	QTY	PART NUMBER	DESCRIPTION
1	1	OSG-LC-77	LEFT CEILING PLATE WITH LIGHT CUT-OUT
2	1	OSG-LC-78	RIGHT CEILING PLATE WITH LIGHT CUT-OUT
3	2	OSG-LC-79	CEILING PLATE
4	38	M6x10-BHCS-A2	M6x10 BUTTONHEAD CAPSCREWS, A2
5	8	M6-HN-ZP	M6 HEXNUT, ZP

2.8.2. Secure the ceiling plates onto each other using M6 button-head screws and hex nuts.

## 2.9. Mechanism and Rotor Assembly

2.9.1. Fit the rotor and mechanism as described in the Installation Manual. The mechanism must be lowered onto the rotor disk with the buffers.

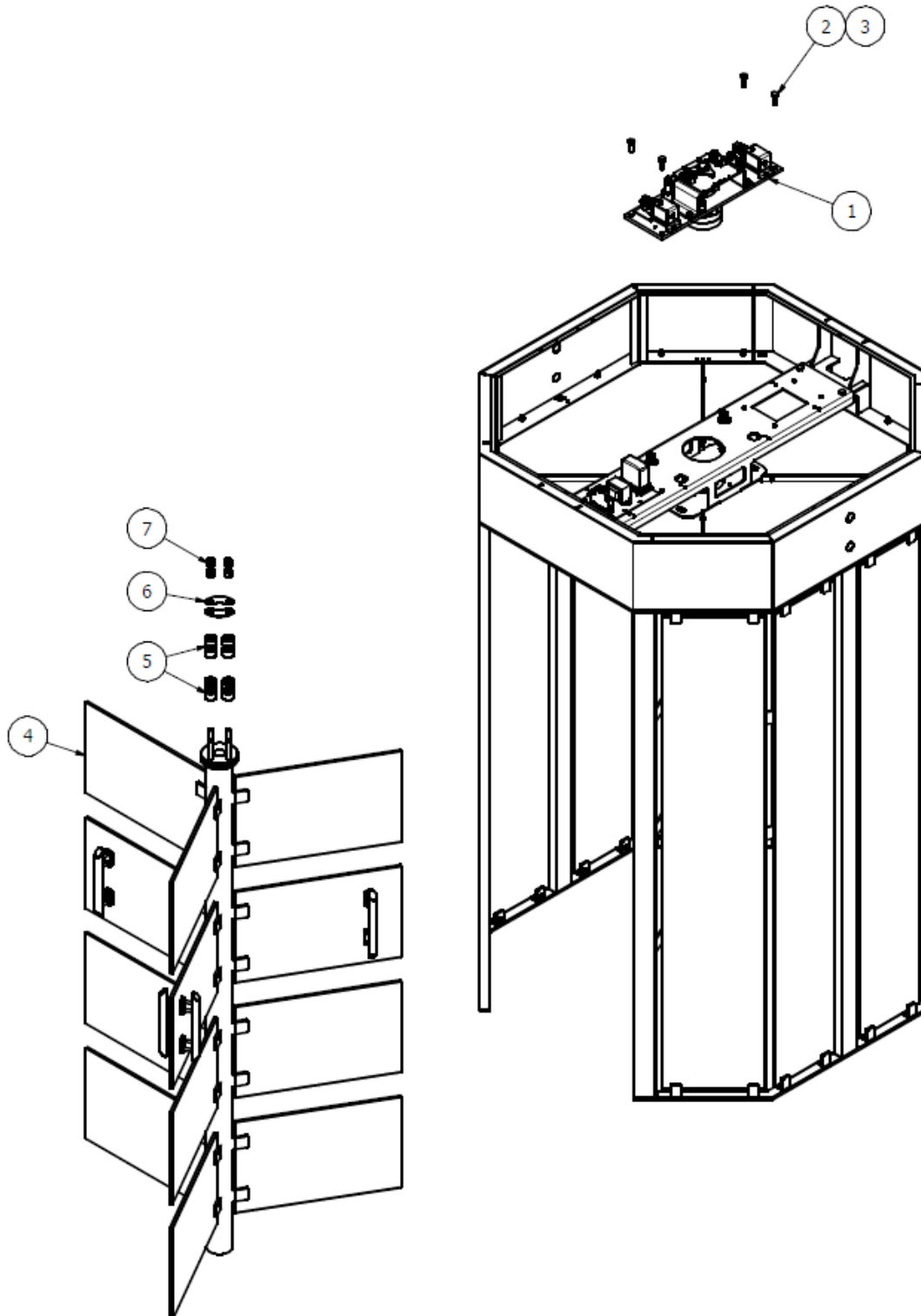

<b>NO</b>	<b>QTY</b>	<b>PART NUMBER</b>	<b>DESCRIPTION</b>
1	1	TSM-AS-02	3-ARM FH MECHANISM - FAIL SECURE
2	4	M12x35-HB-ZP	M12x35 HEXBOLT, ZP
3	4	M12-HN-ZP	M12 HEXNUT, ZINC PLATED
4	1	OSG-SA-14	ROTOR ASSEMBLY
5	8	BUFRUBTD	40x16x25 RUBBER BUFFER
6	4	FHT-LC-33	BEAN WASHER
7	4	M16-HNN-ZP	M16 HEX NYLOCK NUT, ZP

2.9.2. Place the bean washers and M16 nylock hex nuts on top of the mechanism disk and tighten.

## 2.10. Top Cover Assembly

2.10.1. Fit the top center cover plate first, and then the side covers into the bulkhead top rim. Secure with M6 button-head screws.

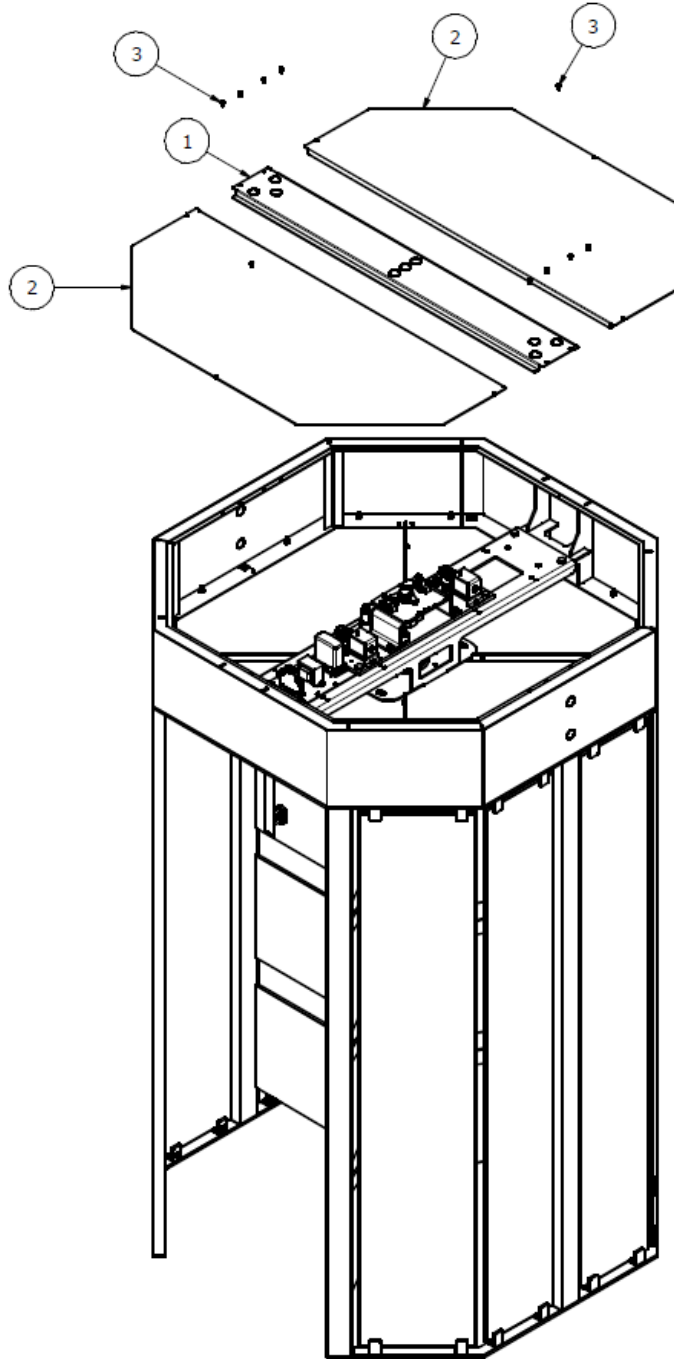

NO	QTY	PART NUMBER	DESCRIPTION
1	1	OSG-LC-81	CENTER COVER PLATE
2	2	OSG-LC-80	SIDE COVER PLATE

3	38	M6x10-BHCS-BLACK	M6x10 BUTTONHEAD CAPSCREW, BLACK
---	----	------------------	----------------------------------